

Kameleon K2/K2+

ASSEMBLY INSTRUCTIONS

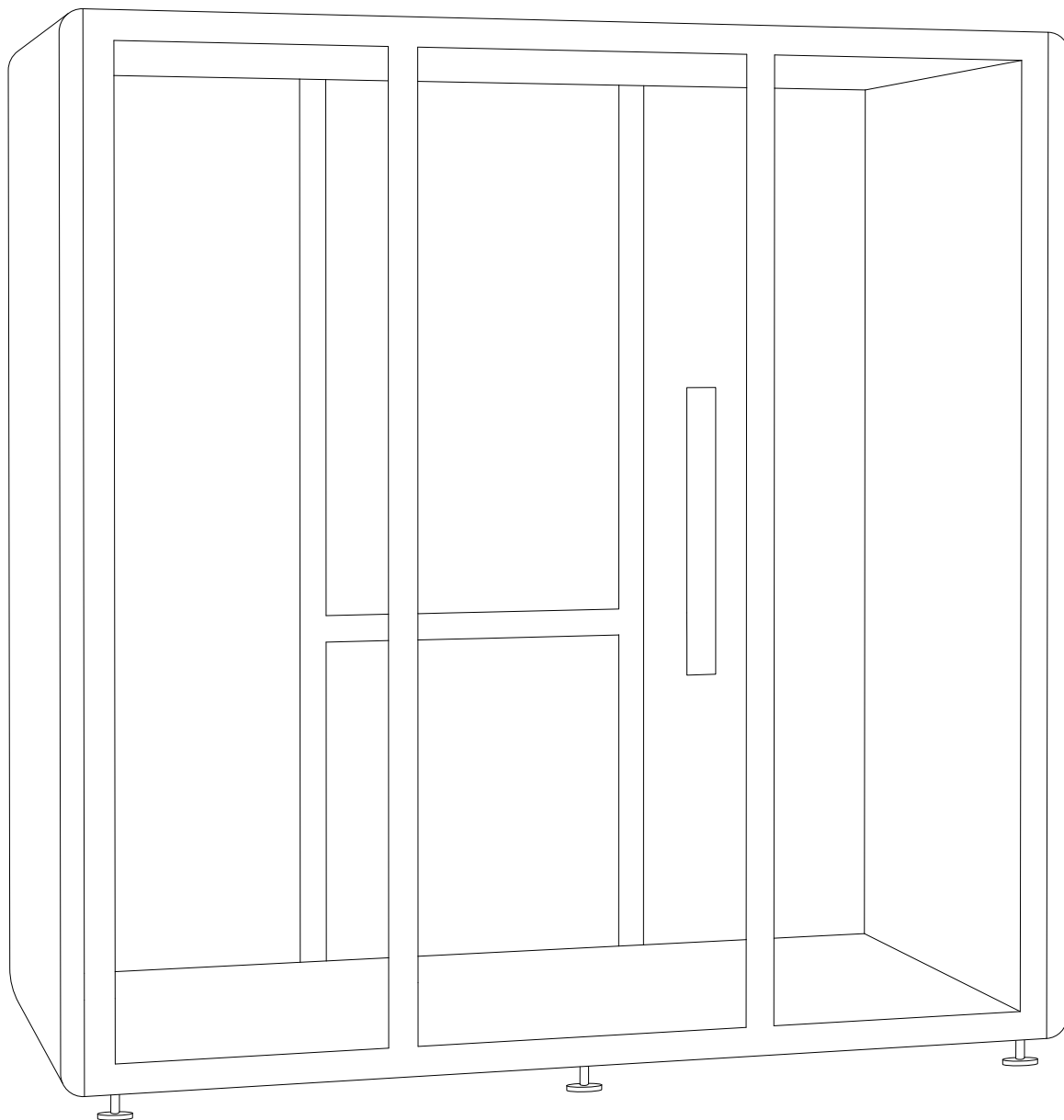

ASKIA
ACOUSTIC PODS

Info.

ASSEMBLY INSTRUCTIONS

1 2 3 Steps.

A B C Bag with screws.

 Unlocked.

 Lock.

 Level check.

 Allen key needed.

 Allen key and screws needed.

 T-Handle hex key needed.

 T-Handle hex key and screws needed.

 Position the door on pins.

 Screwdriver needed.

 Power drill needed.

 Move in place.



Main Internet supply.



Main Power supply.



Ventilation coupling.



Power coupling.



Ethernet coupling.



Lighting coupling.



Motion sensor coupling.



Magnetic coupling element.

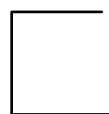

Pay attention to.



Pay attention to.



Do.



Don't.



Pay attention not to break the glass.



Ok.



Stop.



Whiteboard.



Pinboard.



VESA Adapter.

Assembly in 65 min. with 3 people

Included

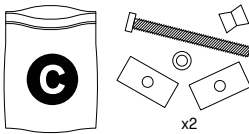
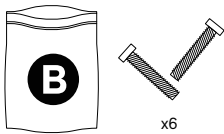
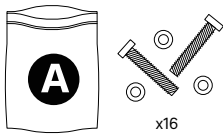
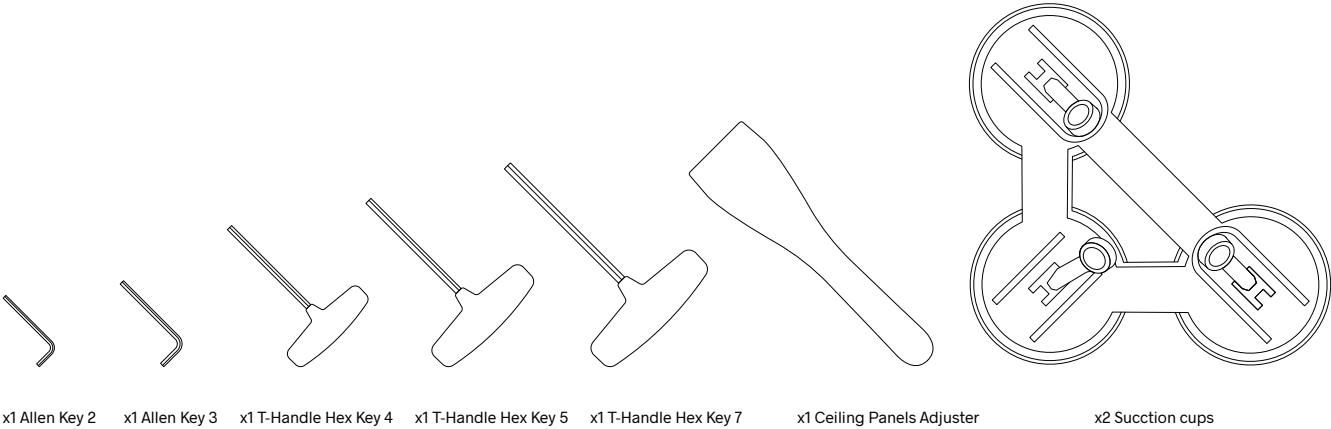

Elements

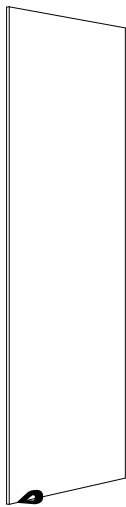

x2 Interior Panels

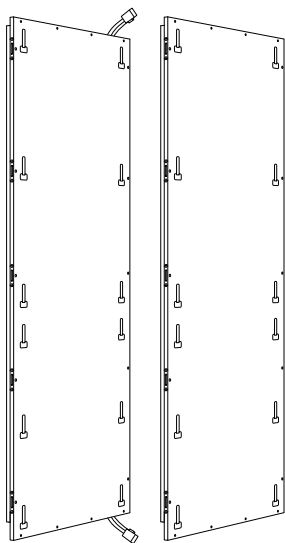

x1 Left & x1 Right Structure Panels

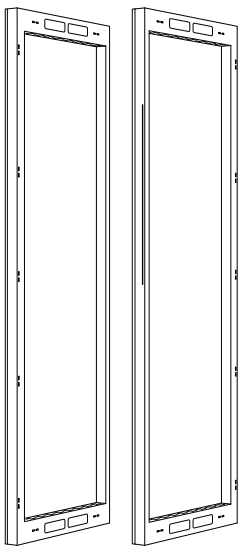

x1 Left & x1 Right Back Glass Walls

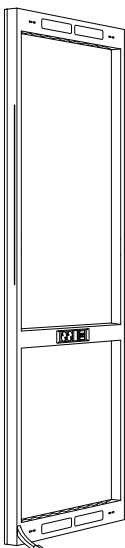

x1 Center Back Glass Wall

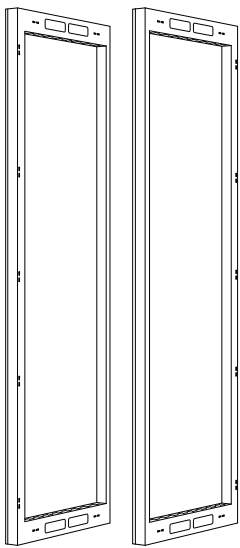

x1 Left & x1 Right Front Glass Walls

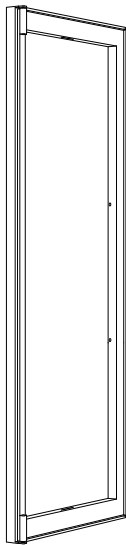

x1 Door Frame

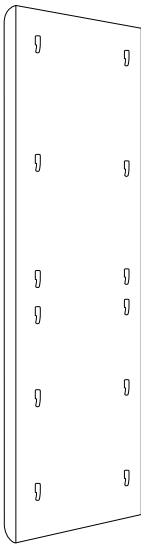

x2 Exterior Panels

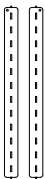

x2 Media adjuster



x1 Door Handle

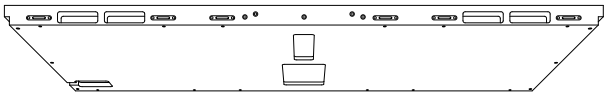

x1 Ceiling



x3 Acoustic Felt Ceiling Panels



x3 Carpet, x2 Dividers

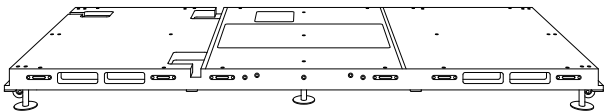

x1 Floor

1

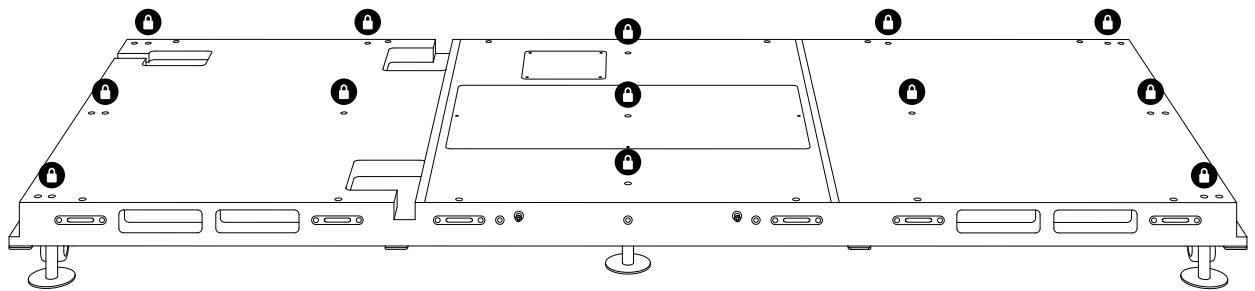

T-Handle Hex Key 4

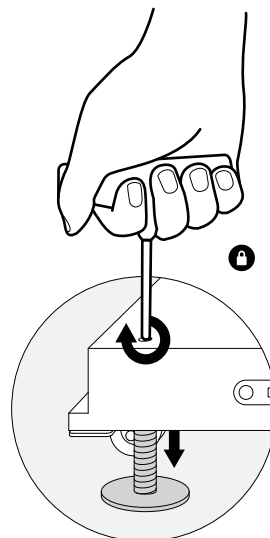
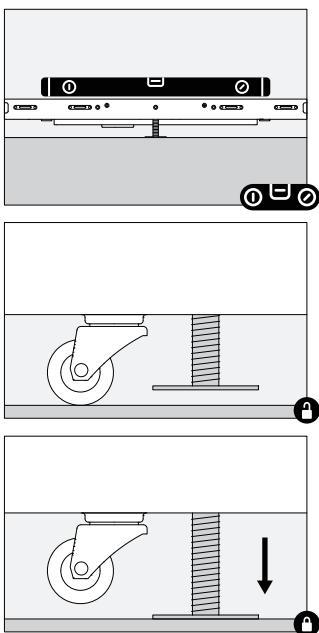

2

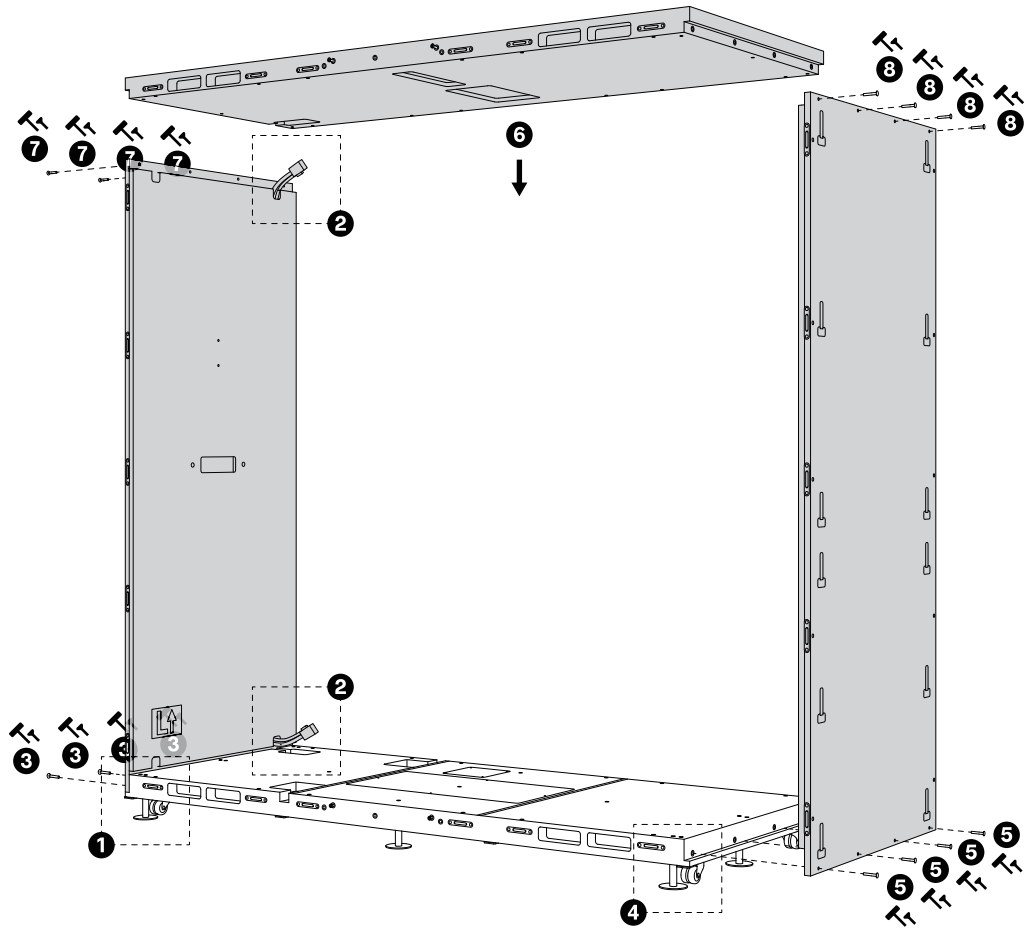

A x16 with
T-Handle Hex Key 4

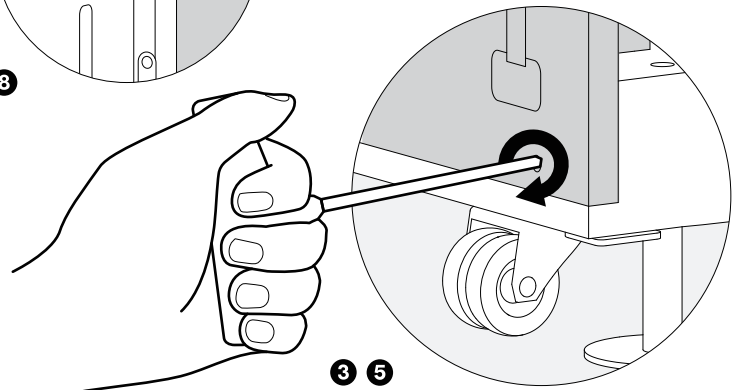
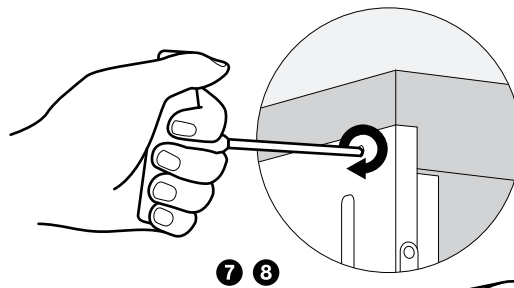
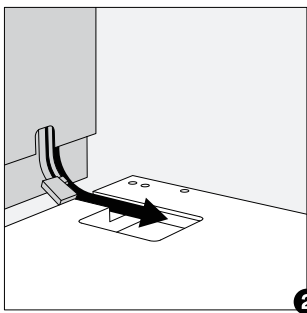
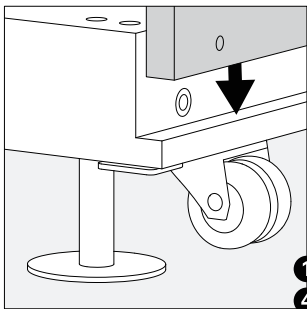
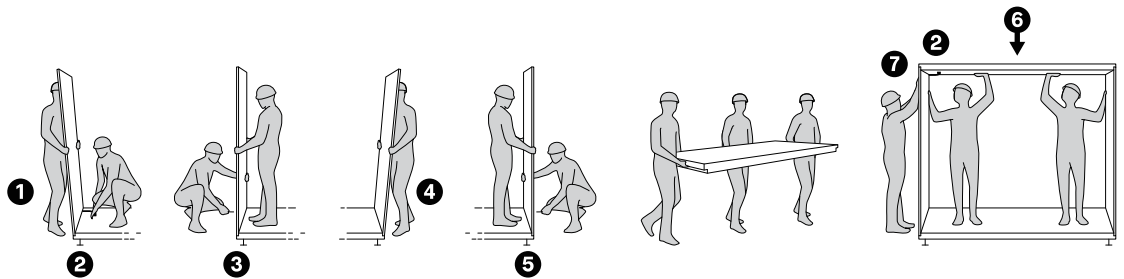

T-Handle Hex Key 7 Suction cup handles

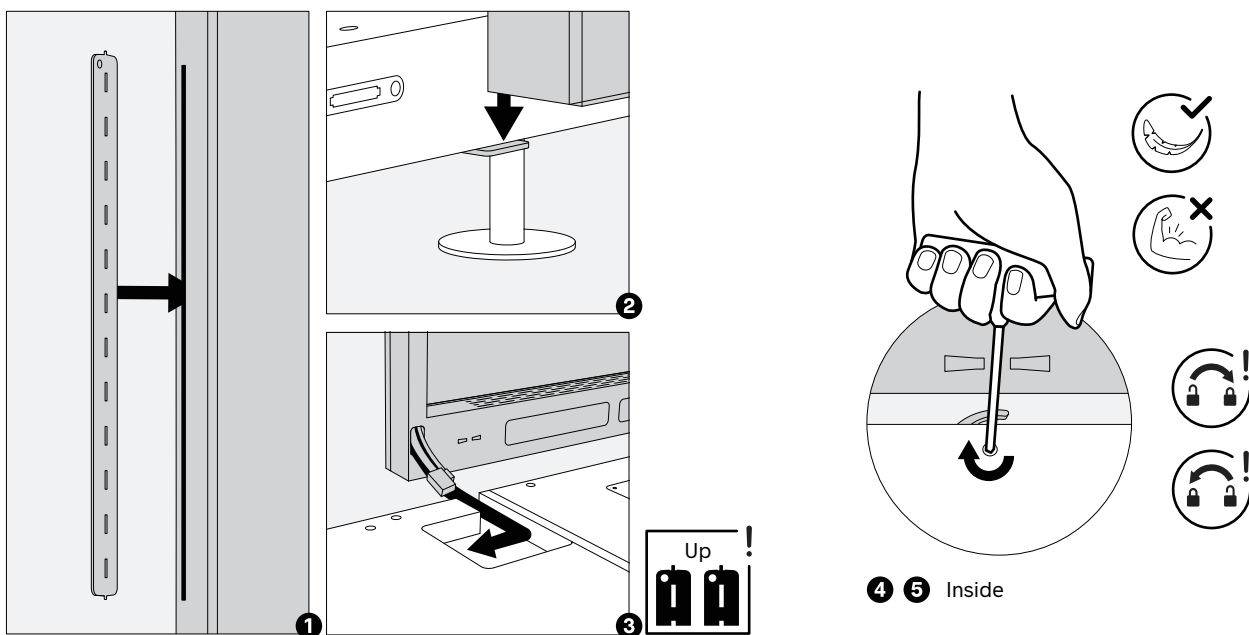
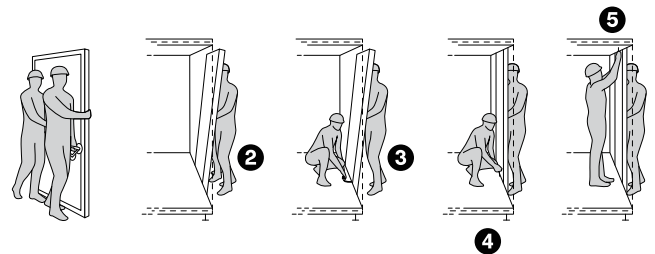

4

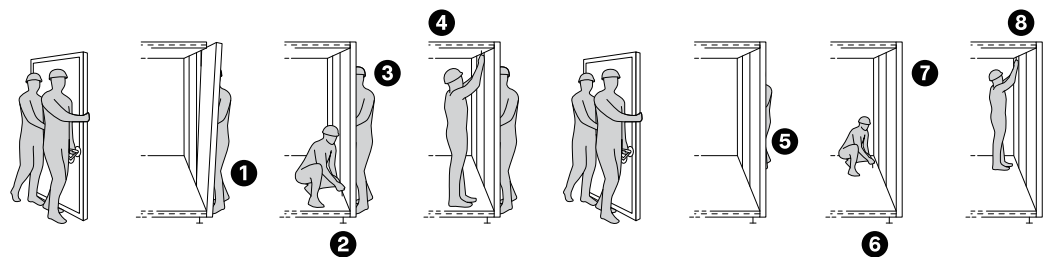
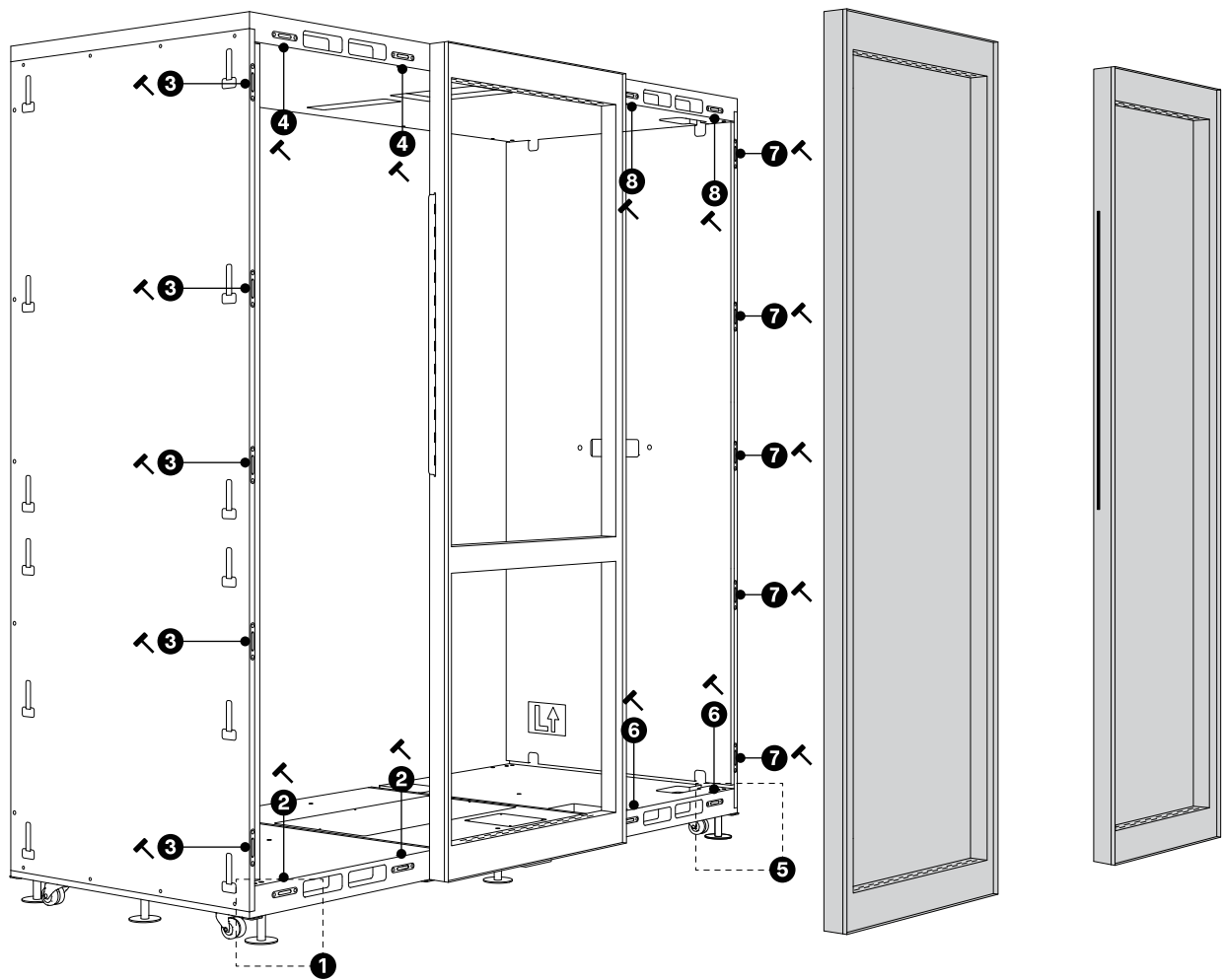

T-Handle Hex Key 7
Suction cup handles

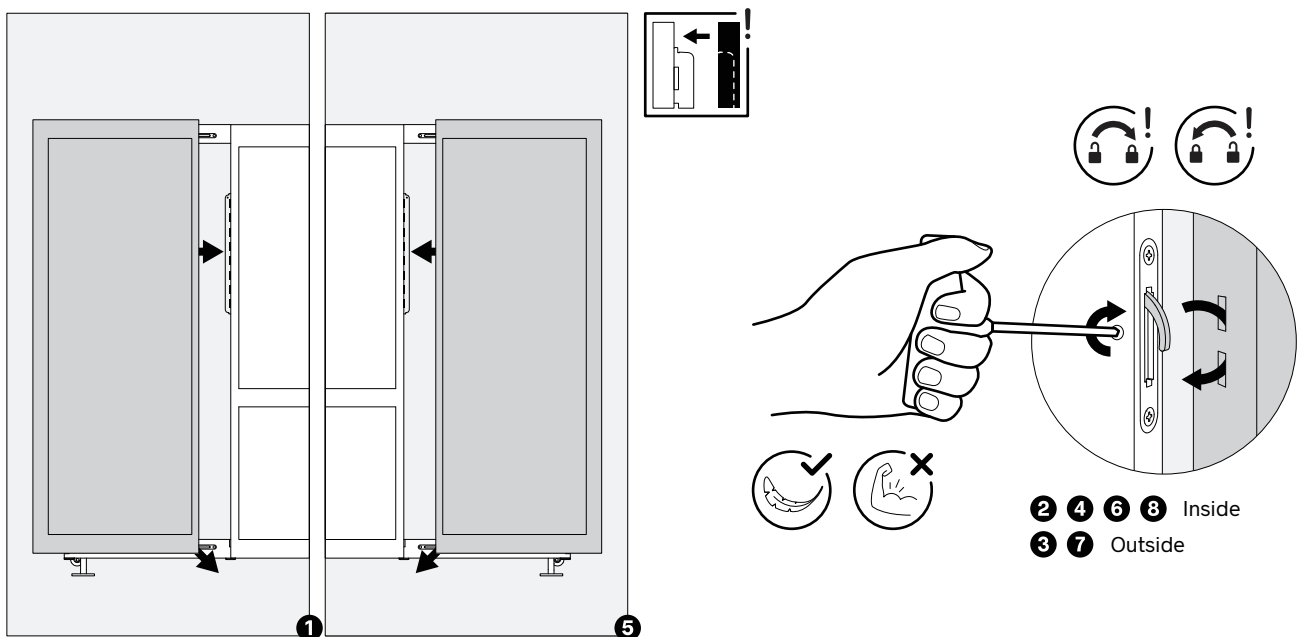

5

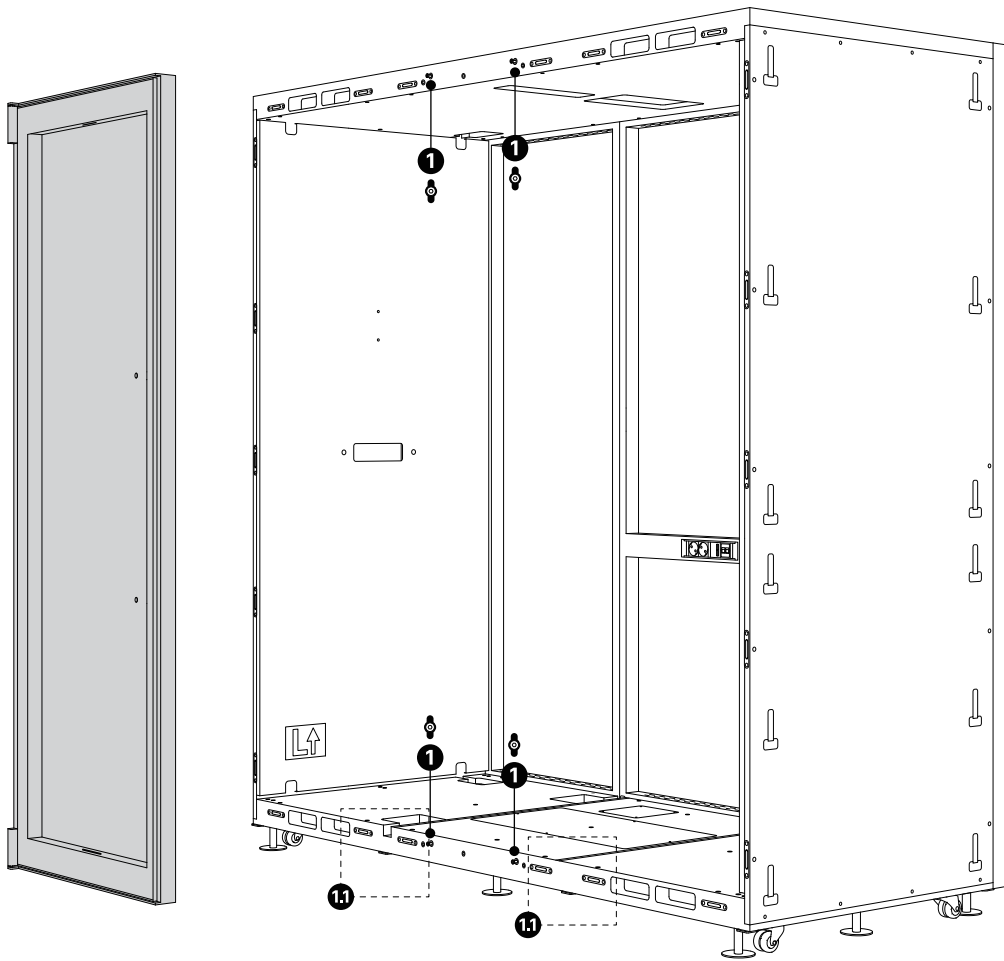

Recommendation

It is recommended to start with the Door Frame.

Suction cup handles

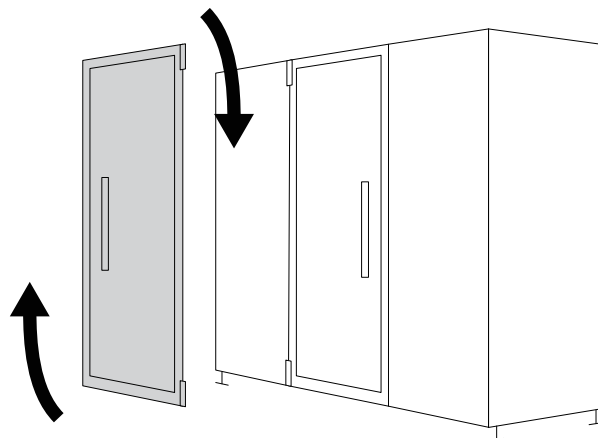
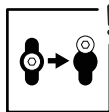
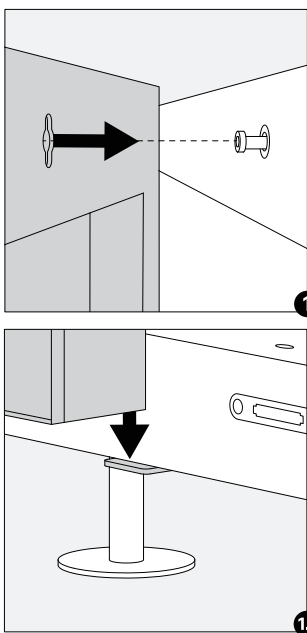
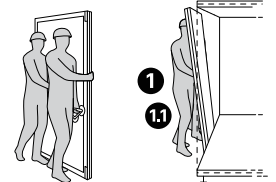

The door opening can be oriented **Left** or **Right** just by rotating the frame.

6

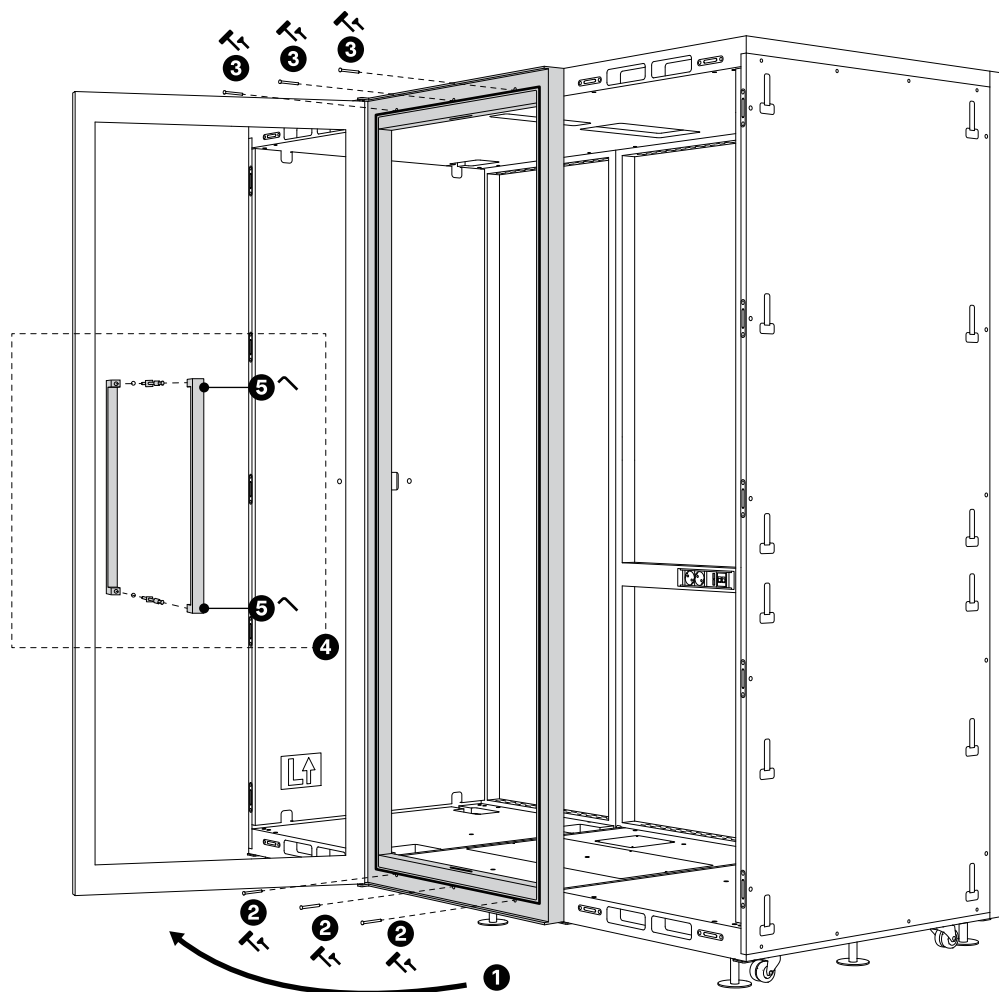

B x6 with
T-Handle Hex Key 4

C x2 with
Allen Key 3

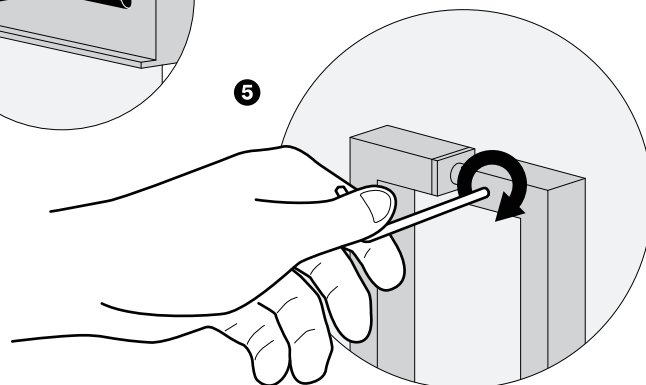
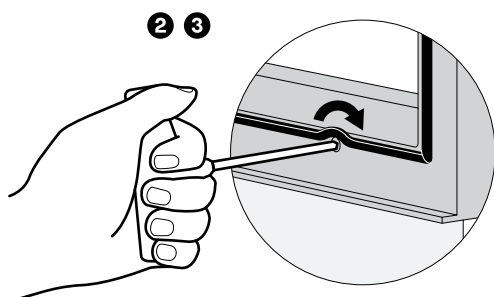
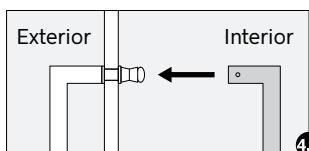
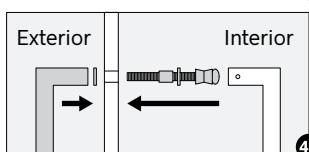
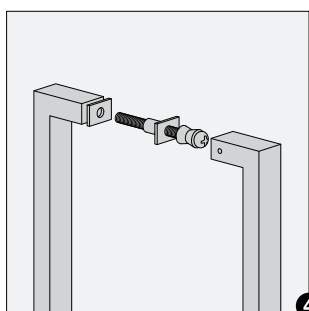
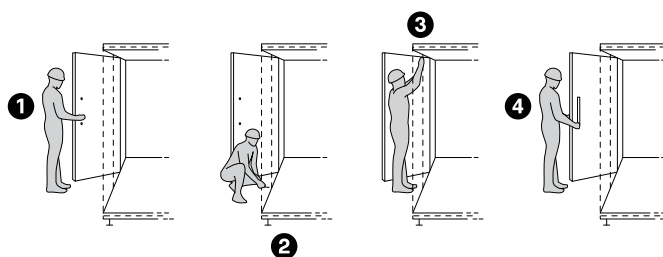

7



Pay attention not to break the glass door.



Pay attention not to break the glass door.



Check if the glass door hits the frame edge before closing it.

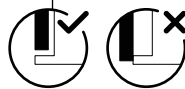

Adjust the glass door if necessary.

2

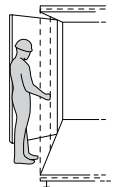

Allen Key 3
Allen Key 2

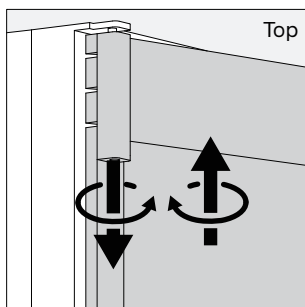

Top

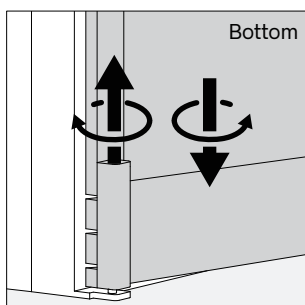

Bottom

1

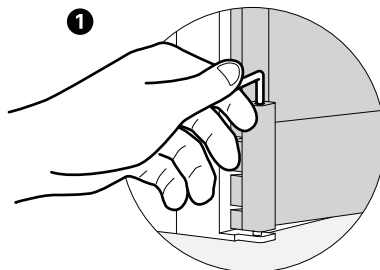

2

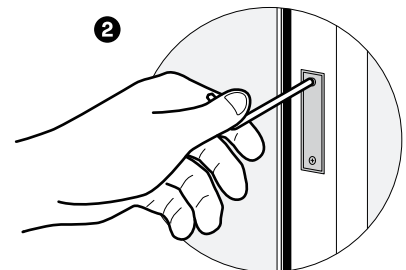

To adjust the glass door the height must be calibrated. If you need to raise the glass door, you loosen the top hinge and tighten the bottom hinge.



If you need to lower the glass door, you loosen the bottom hinge and tighten the top hinge.



Check if the door closes properly and adjust the door plates if needed.



Tighten or loosen the plates when needed.

8

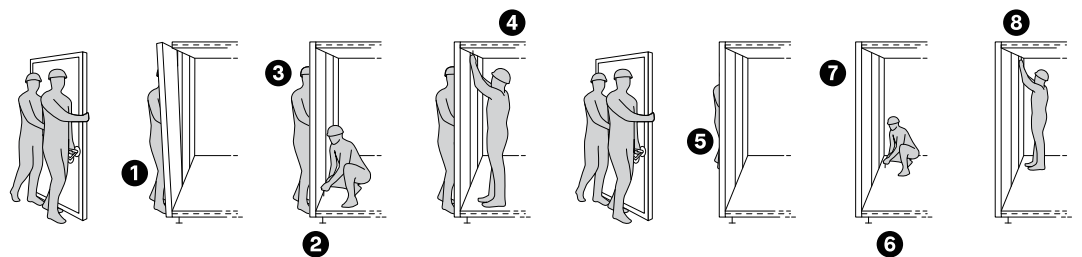
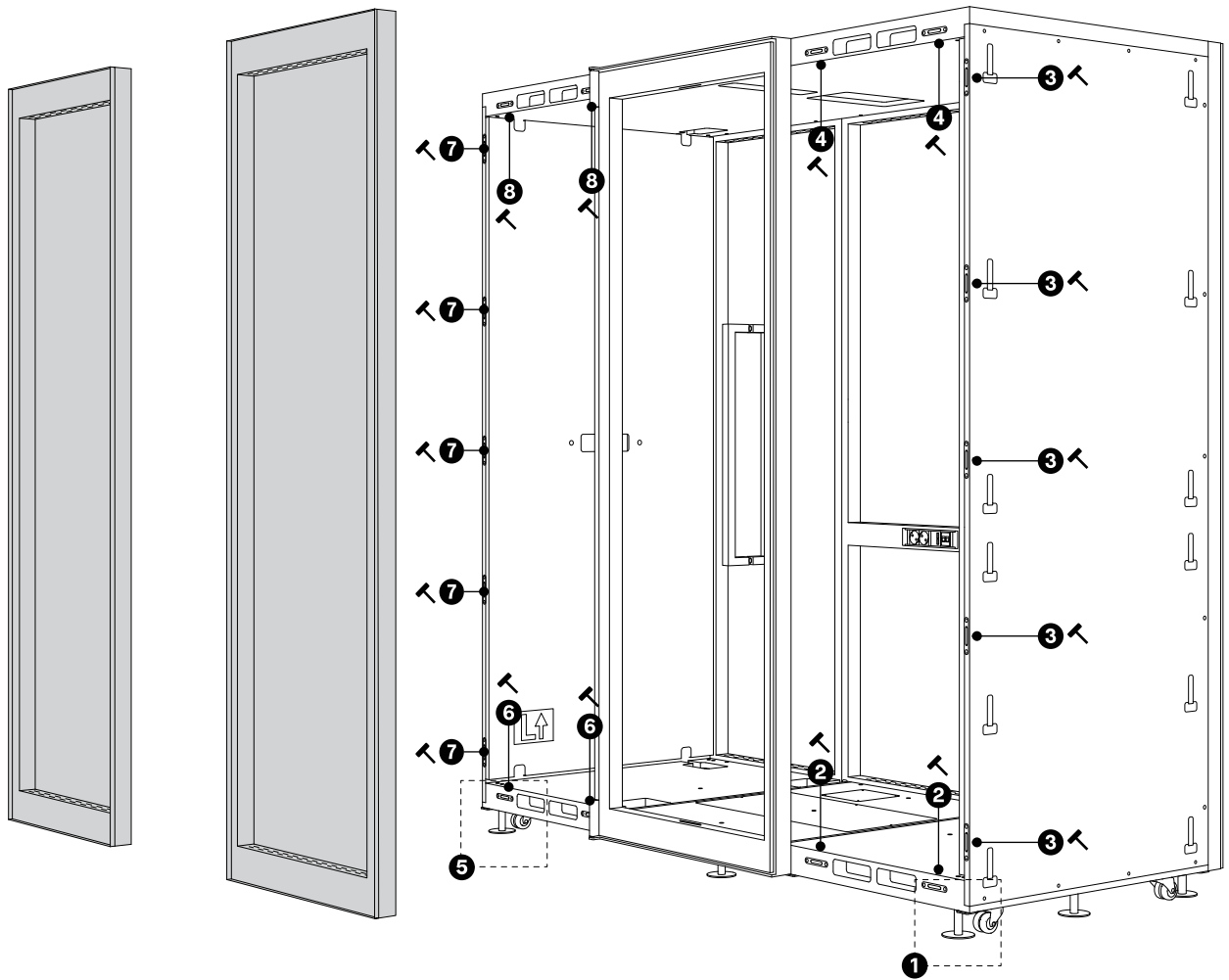

T-Handle Hex Key 7
Suction cup handles

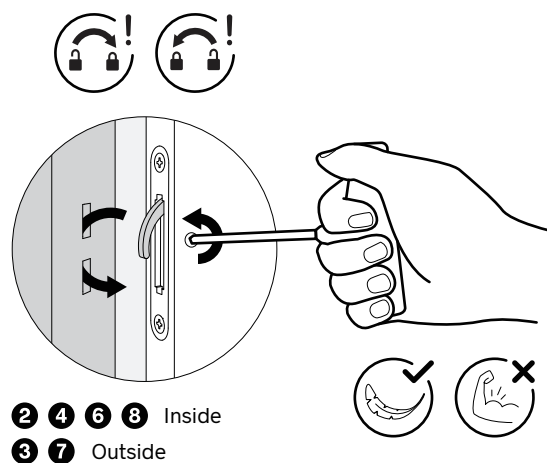
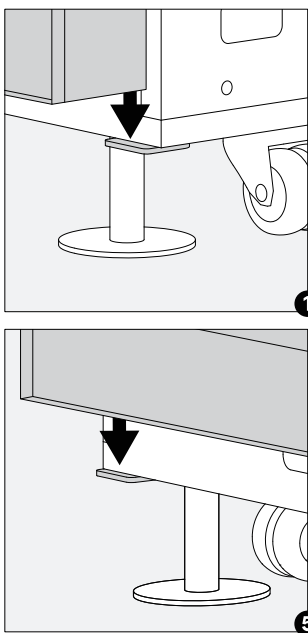

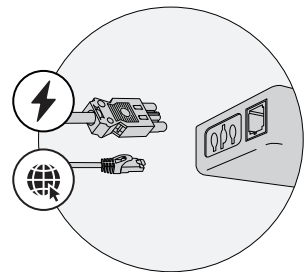
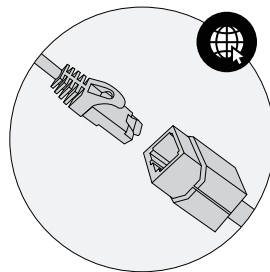
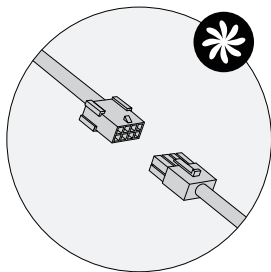
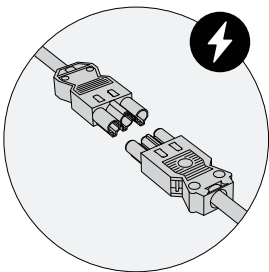
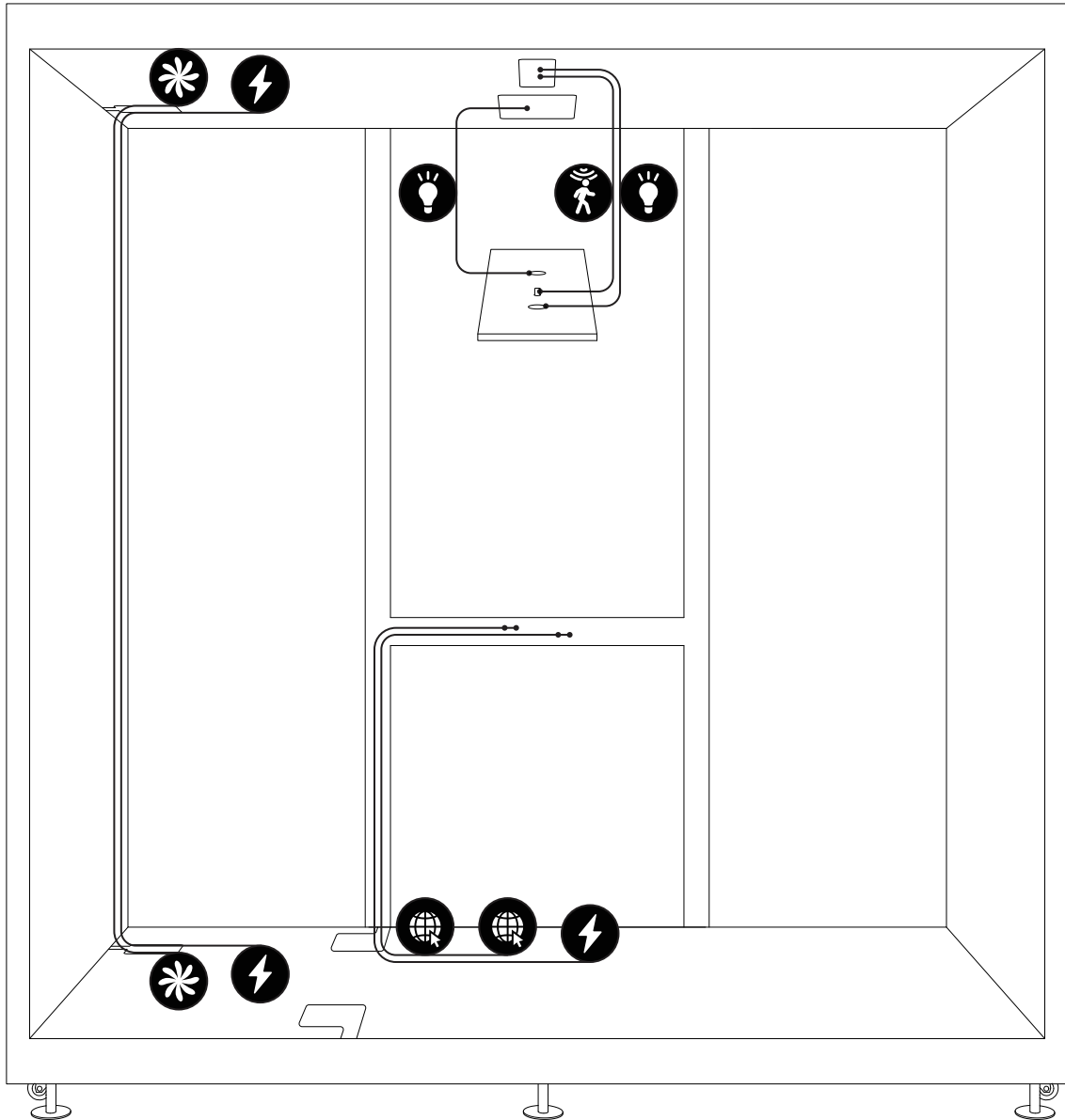

Orange

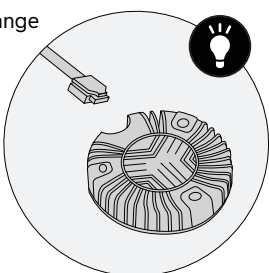

Black

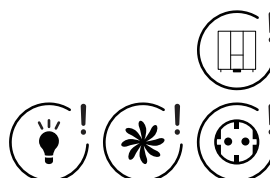
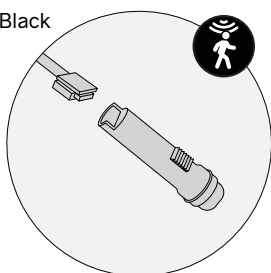

Main Power & Ethernet supply at the back of the pod.

Check if the lighting, ventilation and power sockets are connected properly.

10

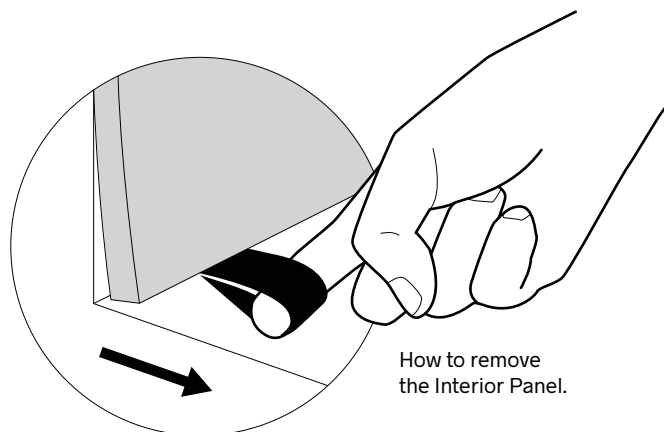
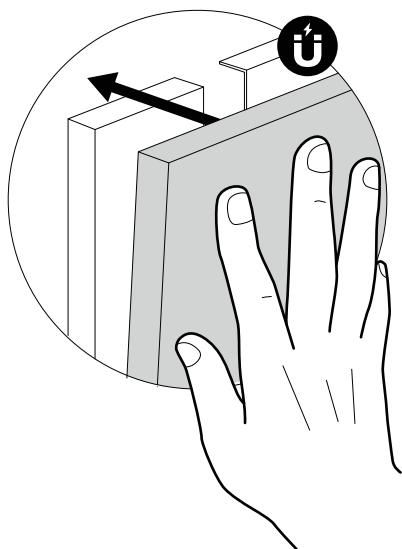
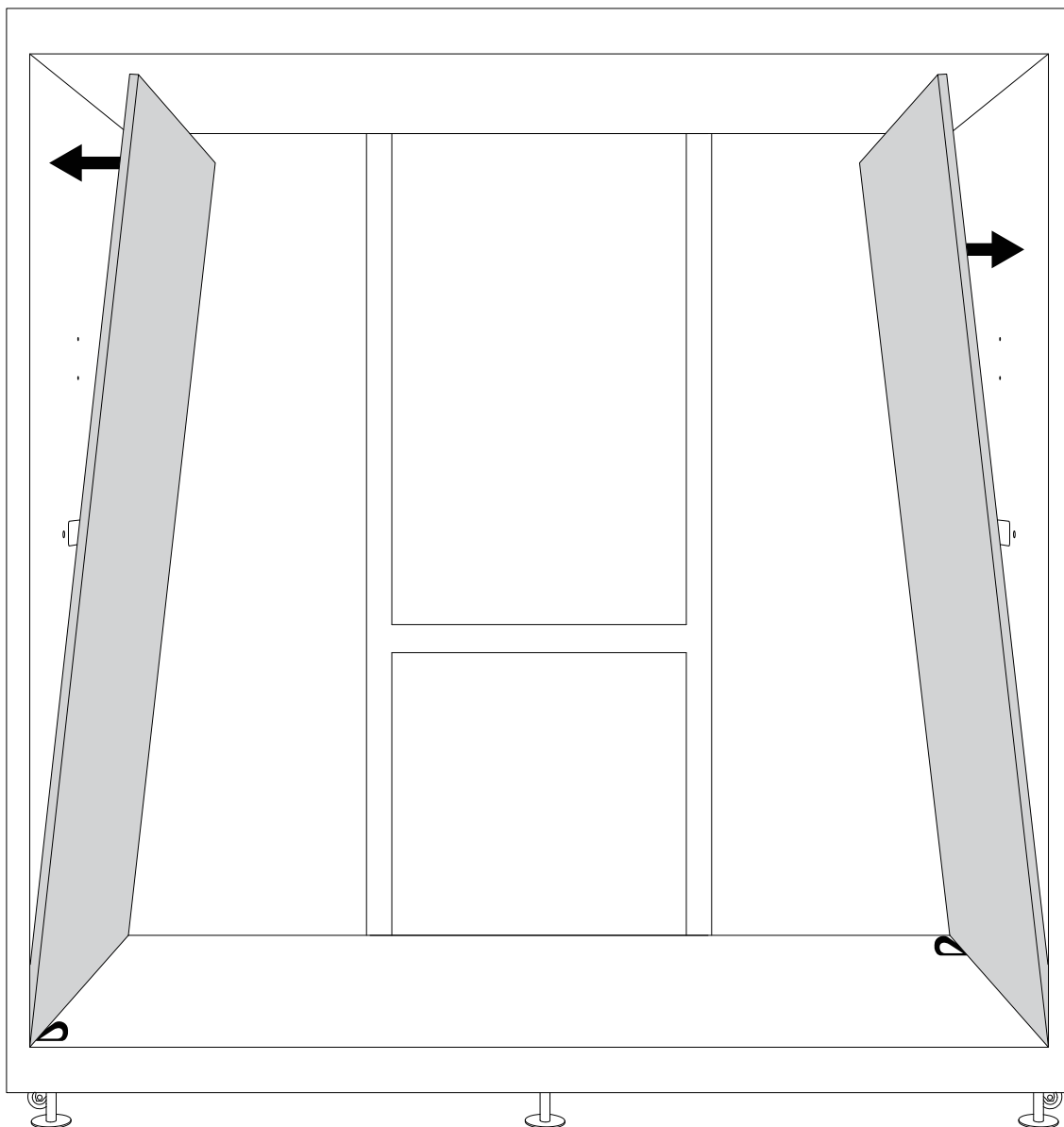

How to remove
the Interior Panel.

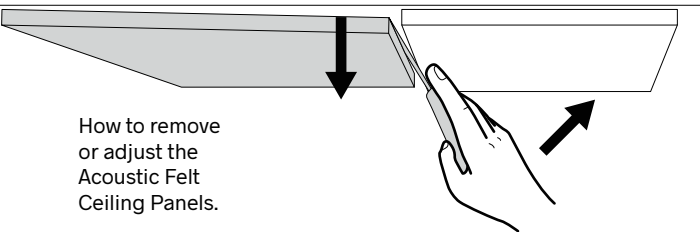
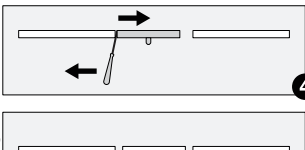
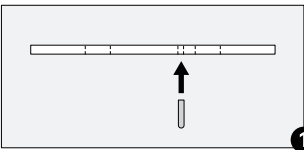
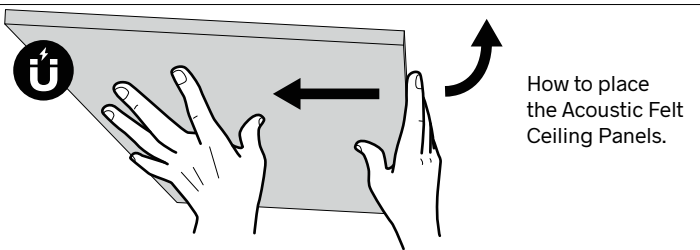
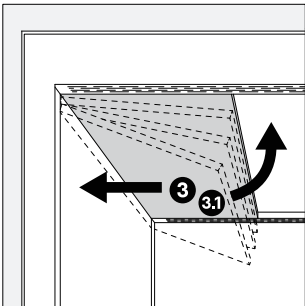
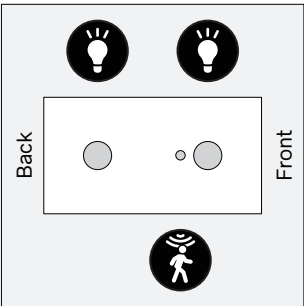
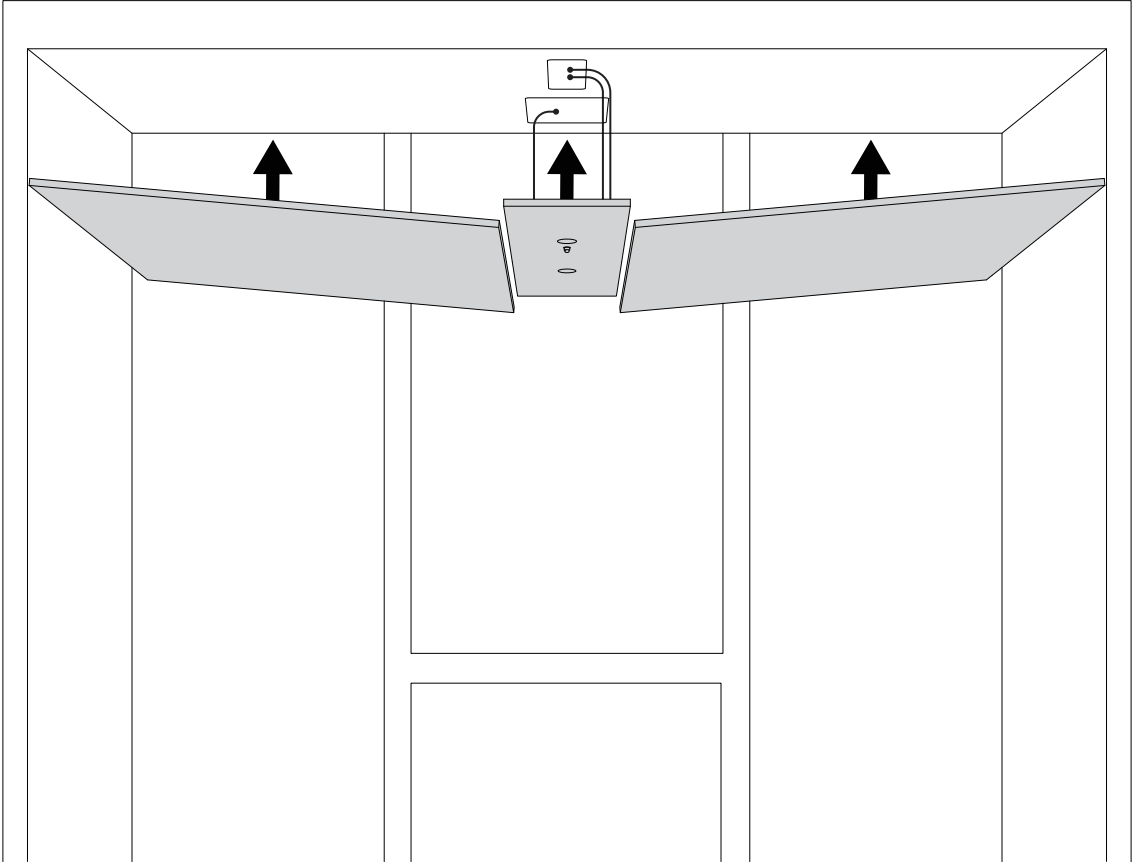

12

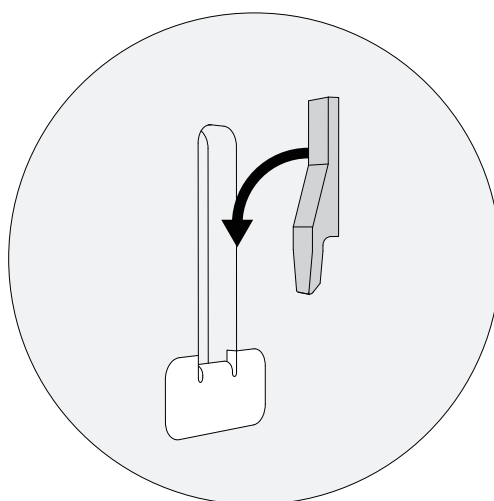
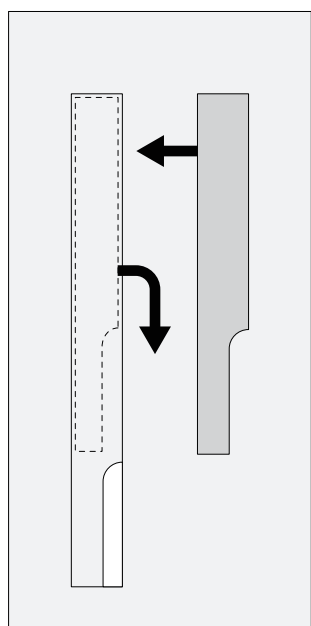
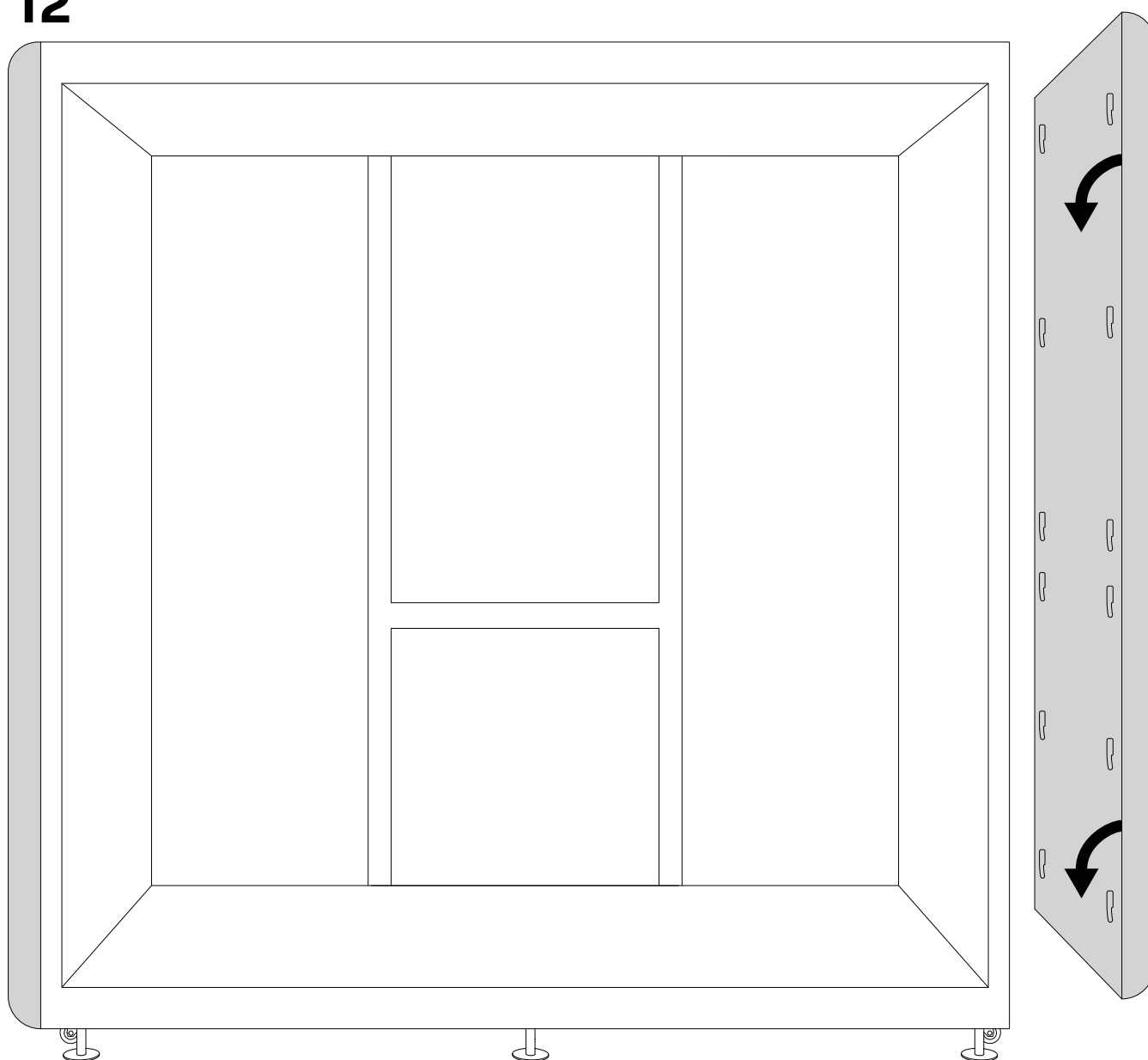

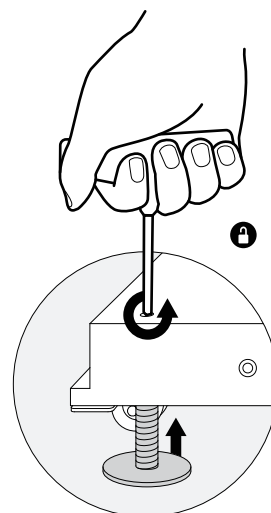
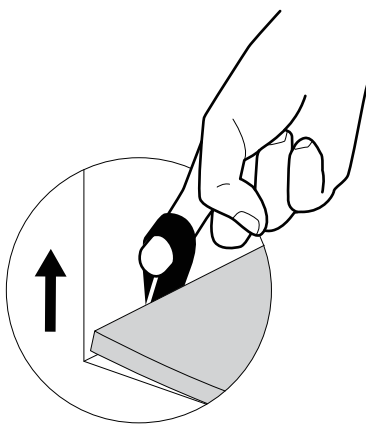
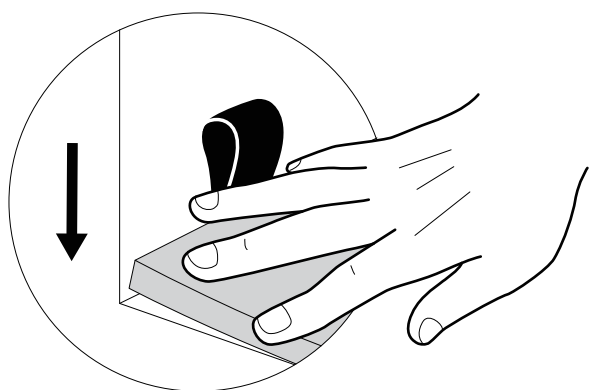
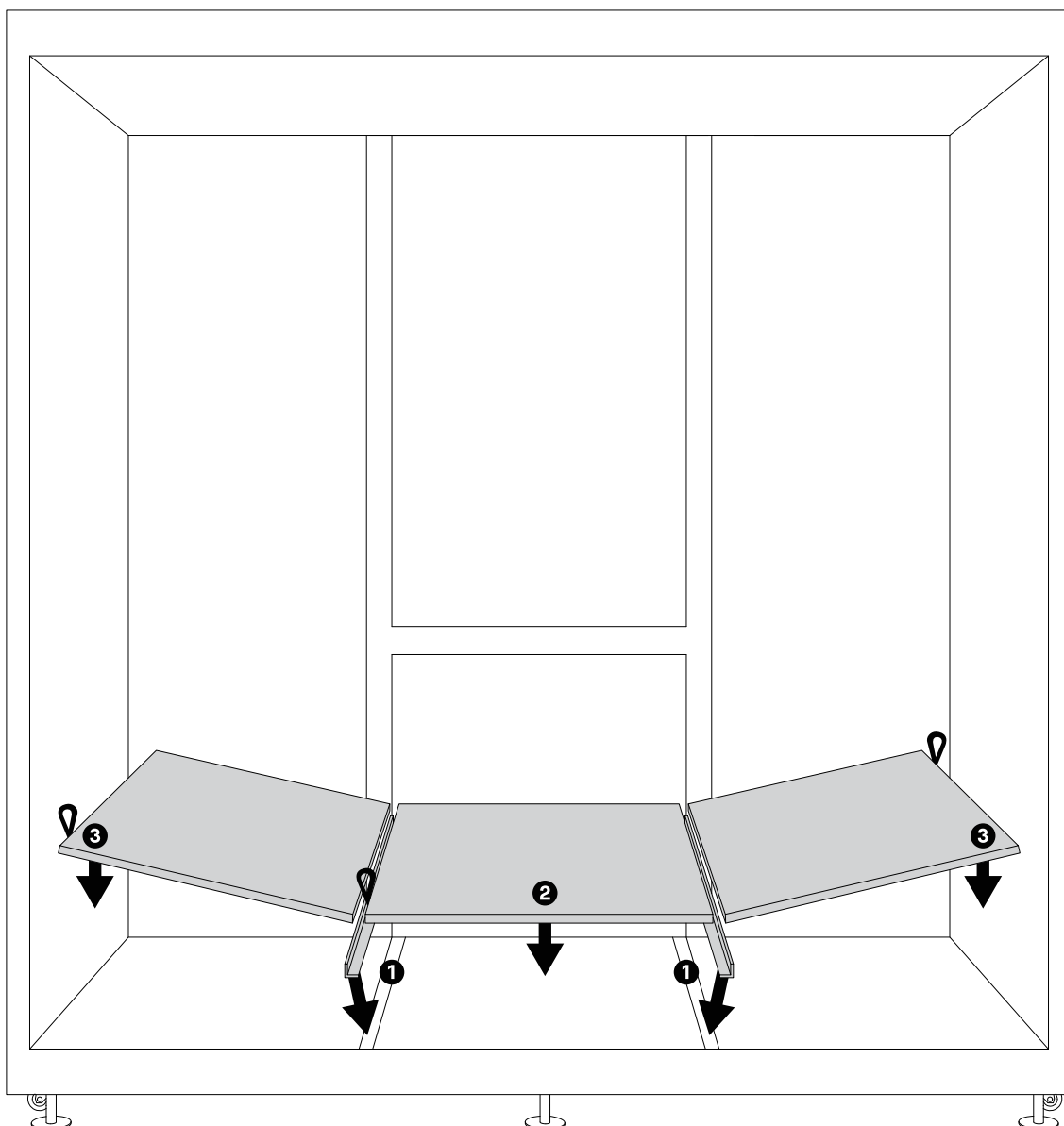

If you are satisfied with the pod's position, you can place the carpets.



If you want to reposition the pod, you have to remove the carpet, if needed, and unlock the legs. When you are satisfied with the pod's position, lock the legs and place the carpets.

Adjustable FAN and LED

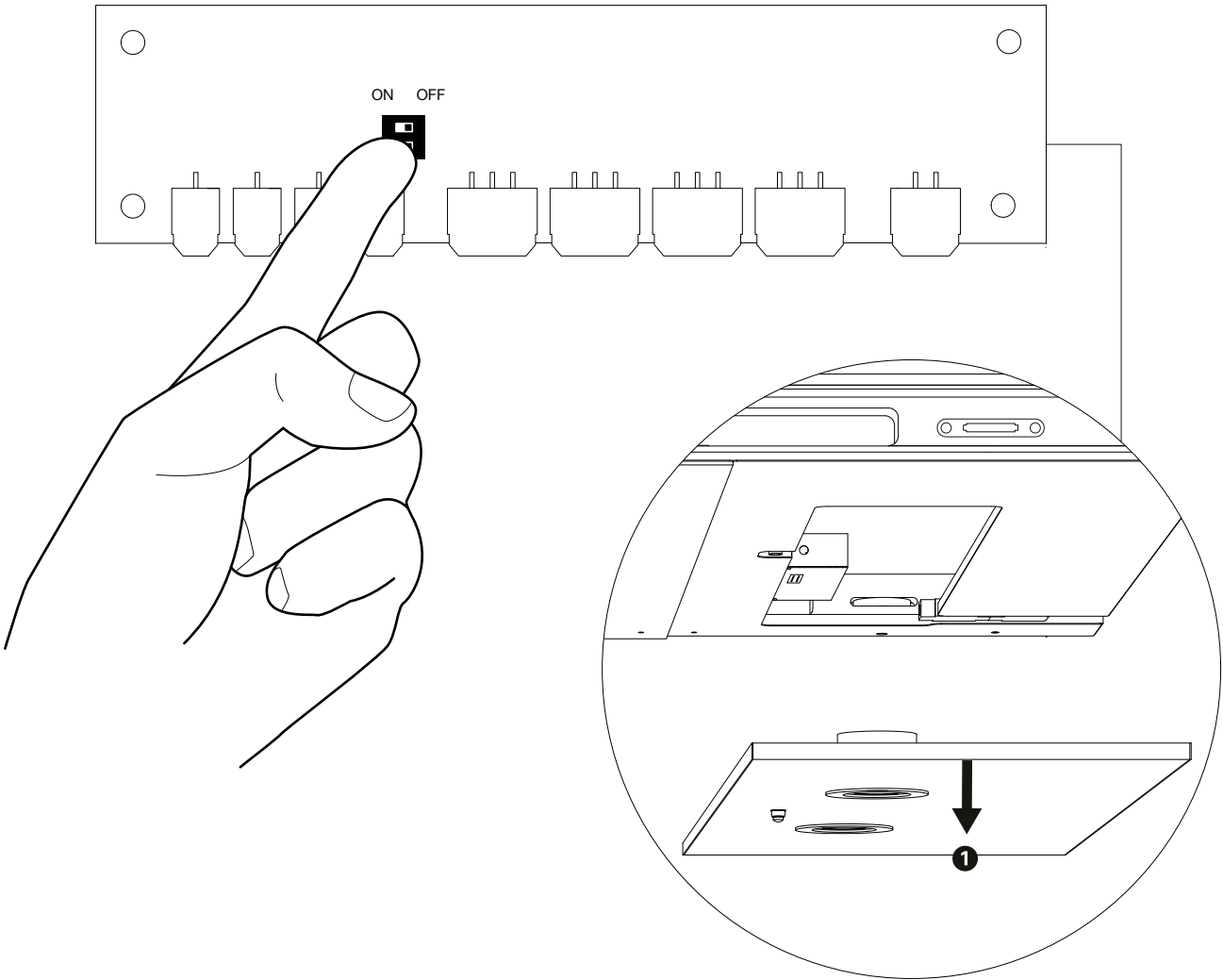

FAN		100%	80%	60%
1	<input type="checkbox"/> ON <input type="checkbox"/> OFF	<input type="checkbox"/> OFF	<input type="checkbox"/> OFF	ON <input type="checkbox"/>
2	<input type="checkbox"/> ON <input type="checkbox"/> OFF	<input type="checkbox"/> OFF	ON <input type="checkbox"/>	ON <input type="checkbox"/>

Scan

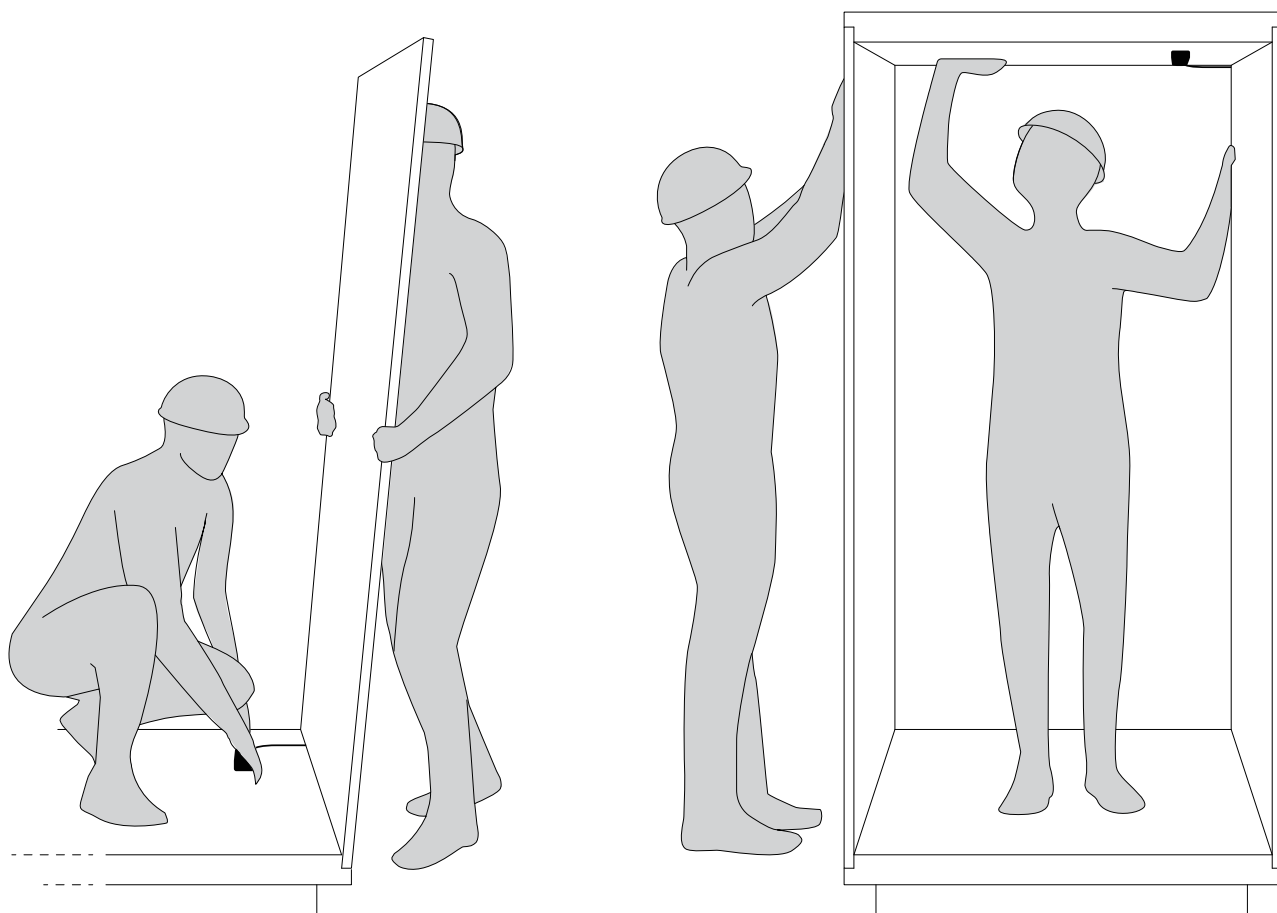

You can watch an instructional video of the K2 assembly process. Thanks to the modular design and limited number of components used for each pod, many steps are similar between different Kameleon pods.



Optional



VESA Adapter

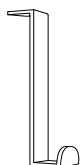

Coat Hanger



Exterior Hanging
Whiteboard or Pinboard

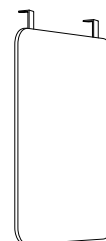

Interior Hanging
Whiteboard or Pinboard



There are multiple features that you can personalize your pod with. You can view them for each Kameleon on our website www.askiafurniture.ro



Eliade Tower,
Mircea Eliade No.18
RO-Bucharest, 012015

T +40 212 121 381
contact@askiafurniture.ro

www.askiafurniture.ro
Last update: 06.02.2023